

# Certificate of Acceptance of new water and/or wastewater assets

Watercare reference number:

9	3	7	3	0			
---	---	---	---	---	--	--	--

Auckland Council EPA number:

6	0	3	0	8	8	1	6		
---	---	---	---	---	---	---	---	--	--

## Site details

Job name: WATER AND WASTEWATER ASSETS

Legal site address: Street number

Street name SIDWELL ROAD

Suburb UPPER OREWA

Postcode 0992

Lot number -

Deposited plan (DP) number -

Certificate of Title (CT) number -

Stage/s that relates to this certificate MILLDALE STAGE 1B

## Certification statement

Watercare has received the following documentation:

- As-built (PDF)
- As-built CAD (DWG)
- Watercare Schedule of assets
- CS3
- CS4

This Watercare Certificate of Acceptance is issued with respect to all aspects of the engineering water and/or wastewater works covered by the above engineering plan approval and to satisfy Auckland Council's engineering approval completion certificate.

The assets have been connected correctly to the existing public networks.

The total value of these assets to be vested to Auckland Council is: **\$ 427,256.83**

## Watercare representative

Full name **NITA DHARMADHIKARI**

Signature 

Date **05 06 2019**

I certify that these As-built Plans are an accurate record of the works undertaken and that:

- The coordinates (X,Y) are in terms of NZTM on NZGD2000
- The Levels (Z) are in terms of Auckland Vertical Datum 1946 (MSL) LINZ datum

Signed: *J Whyte*  
 Registered Professional Surveyor  
 Date: 14/03/2019  
 Name: Jamie Whyte

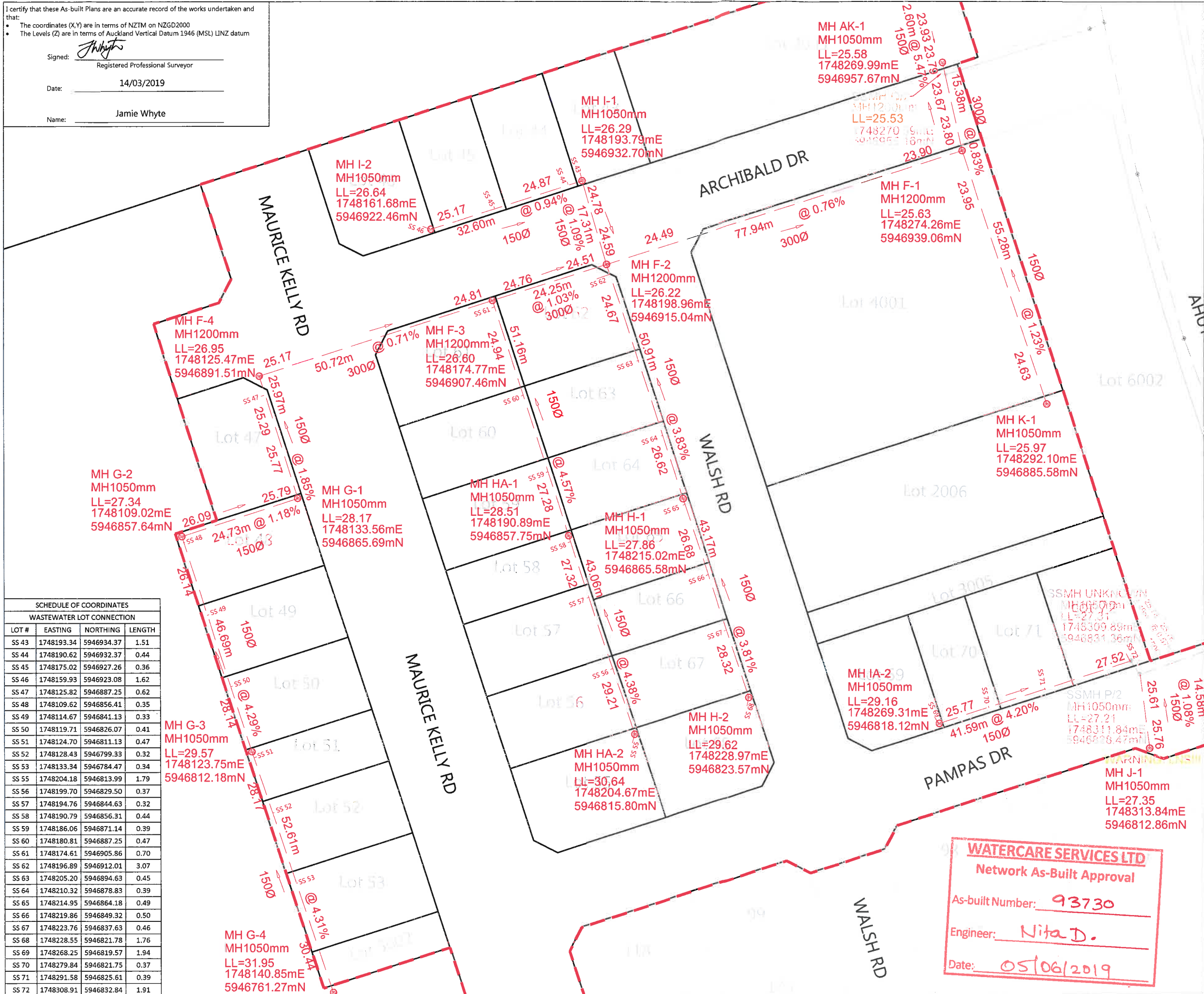
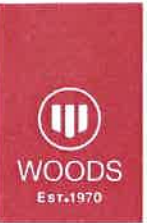

**LEGEND**

NEW SANITARY SEWER MANHOLE	
NEW SANITARY SEWER	
EXISTING SANITARY SEWER	
UPDATED SEWER DATA	LL= 25.53
LOT BOUNDARIES	
STAGE BOUNDARY	

- NOTES**
- ALL WORKS AND MATERIALS COMPLY WITH AUCKLAND COUNCIL & WATERCARE SERVICES LTD STANDARDS FOR ENGINEERING DESIGN AND CONSTRUCTION.
  - ALL SANITARY SEWER LINES ARE 150mmØ uPVC CLASS SN16 UNLESS STATED OTHERWISE.
  - ALL PIPE BEDDING COMPLIES WITH WATERCARE STANDARDS.
  - ALL PIPE CROSSINGS UNDER ROADS AND ACCESSWAYS HAVE BEEN HARDFILL BACKFILLED.
  - ALL PRIVATE LOT CONNECTIONS ARE 100mmØ
  - LOT BOUNDARIES ARE SUBJECT TO FINAL SURVEY.
  - ALL PIPE AND MH DIAMETERS ARE INTERNAL AND SHOWN IN MILLIMETERS UNLESS OTHERWISE SPECIFIED.
  - ASBUILT DATA HAS BEEN SOURCED FROM A COMBINATION OF WOODS SURVEY MEASURED DATA AND CONTRACTOR RECEIVED DATA.

**SCHEDULE OF COORDINATES**  
**WASTEWATER LOT CONNECTION**

LOT #	EASTING	NORTHING	LENGTH
SS 43	1748193.34	5946934.37	1.51
SS 44	1748190.62	5946932.37	0.44
SS 45	1748175.02	5946927.26	0.36
SS 46	1748159.93	5946923.08	1.62
SS 47	1748125.82	5946887.25	0.62
SS 48	1748109.62	5946856.41	0.35
SS 49	1748114.67	5946841.13	0.33
SS 50	1748119.71	5946826.07	0.41
SS 51	1748124.70	5946811.13	0.47
SS 52	1748128.43	5946799.33	0.32
SS 53	1748133.34	5946784.47	0.34
SS 55	1748204.18	5946813.99	1.79
SS 56	1748199.70	5946829.50	0.37
SS 57	1748194.76	5946844.63	0.32
SS 58	1748190.79	5946856.31	0.44
SS 59	1748186.06	5946871.14	0.39
SS 60	1748180.81	5946887.25	0.47
SS 61	1748174.61	5946905.86	0.70
SS 62	1748196.89	5946912.01	3.07
SS 63	1748205.20	5946894.63	0.45
SS 64	1748210.32	5946878.83	0.39
SS 65	1748214.95	5946864.18	0.49
SS 66	1748219.86	5946849.32	0.50
SS 67	1748223.76	5946837.63	0.46
SS 68	1748228.55	5946821.78	1.76
SS 69	1748268.25	5946819.57	1.94
SS 70	1748279.84	5946821.75	0.37
SS 71	1748291.58	5946825.61	0.39
SS 72	1748308.91	5946832.84	1.91

**REVISION DETAILS**

NO	ISSUED FOR INFORMATION	BY	DATE
1	ISSUED FOR INFORMATION	KR	14/03/19

SURVEYED	WOODS	WOODS Ltd LEVEL 1 BUILDING B 8 NUGENT STREET, GRAFTON AUCKLAND 1023 09 308 9229 WOODS.CO.NZ
DESIGNED	TB	
DRAWN	KR	
CHECKED	TB	
APPROVED	JW	



**MILLDALE**  
**STAGE 1B**  
 WASTEWATER  
 ASBUILT PLAN

STATUS	ISSUED FOR INFORMATION	REV
SCALE	1: 750 @ A3	1
COUNCIL	AUCKLAND COUNCIL	
DWG NO	P17-295-01B-400-AB	

**WATERCARE SERVICES LTD**  
 Network As-Built Approval  
 As-built Number: 93730  
 Engineer: Nita D.  
 Date: 05/06/2019



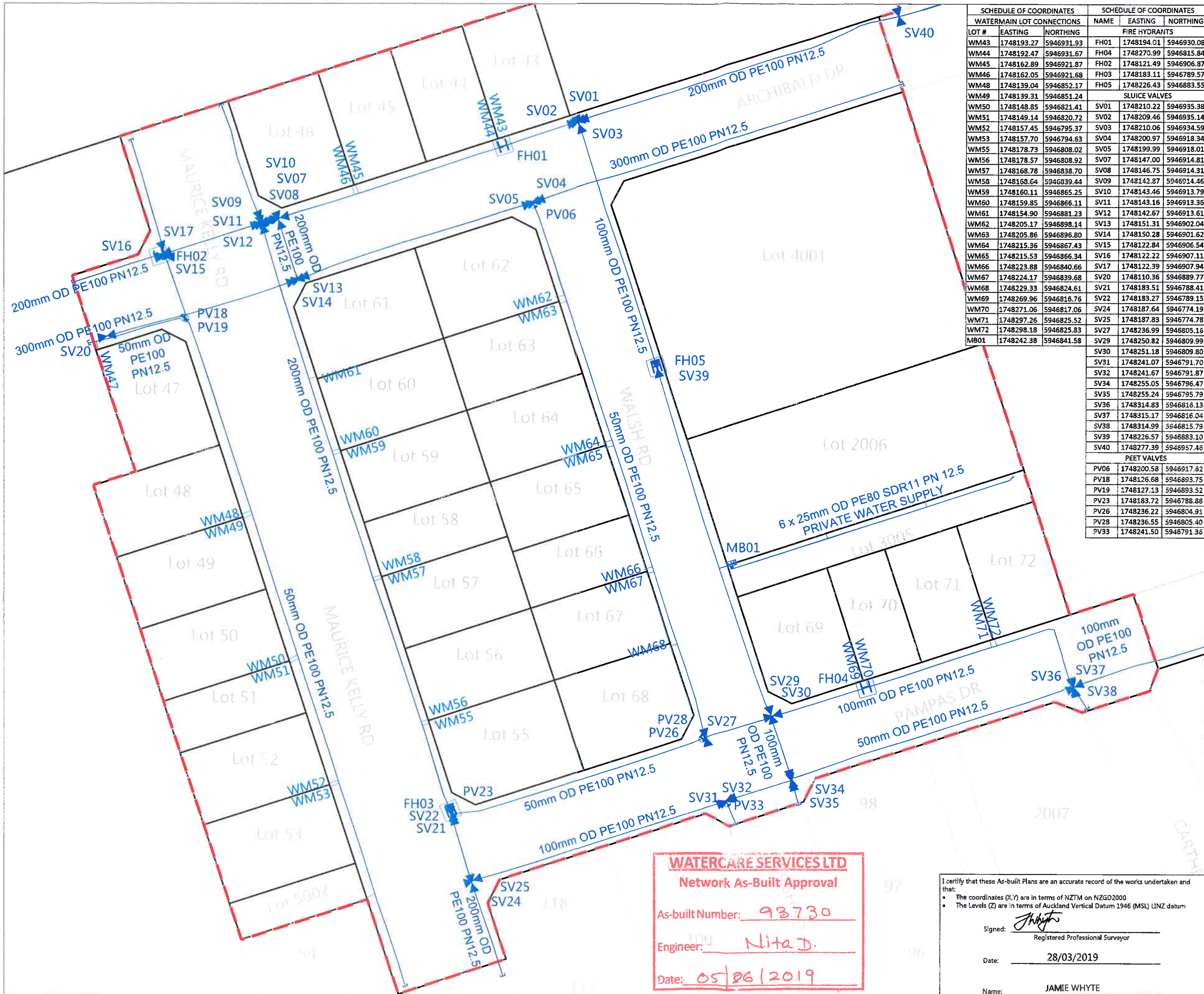

SCHEDULE OF COORDINATES				SCHEDULE OF COORDINATES			
WATERMAIN LOT CONNECTIONS		NAME		EASTING		NORTHING	
LOT #	EASTING	NORTHING					
WM43	1748193.27	5946931.93	FH01	1748194.01	5946930.08		
WM44	1748192.47	5946931.67	FH04	1748270.99	5946815.84		
WM45	1748162.89	5946921.87	FH02	1748121.49	5946906.87		
WM46	1748162.05	5946921.68	FH03	1748183.11	5946789.57		
WM48	1748139.04	5946852.17	FH05	1748226.43	5946883.55		
WM49	1748139.31	5946851.24					
SLUICE VALVES							
WM50	1748148.85	5946821.41	SV01	1748210.22	5946935.38		
WM51	1748149.14	5946820.72	SV02	1748209.46	5946935.14		
WM52	1748157.45	5946795.37	SV03	1748210.06	5946934.59		
WM53	1748157.70	5946794.63	SV04	1748200.97	5946918.34		
WM55	1748178.73	5946808.02	SV05	1748199.99	5946918.01		
WM56	1748178.57	5946808.92	SV07	1748147.00	5946914.81		
WM57	1748168.78	5946838.70	SV08	1748146.75	5946914.31		
WM58	1748168.64	5946839.44	SV09	1748142.87	5946914.46		
WM59	1748160.11	5946865.25	SV10	1748143.46	5946913.79		
WM60	1748159.85	5946866.11	SV11	1748143.16	5946913.36		
WM61	1748154.90	5946881.23	SV12	1748142.67	5946913.61		
WM62	1748205.17	5946898.14	SV13	1748151.31	5946902.04		
WM63	1748205.86	5946896.80	SV14	1748150.28	5946901.62		
WM64	1748215.36	5946867.43	SV15	1748122.84	5946906.54		
WM65	1748215.53	5946866.34	SV16	1748122.22	5946907.11		
WM66	1748223.88	5946840.66	SV17	1748122.39	5946907.94		
WM67	1748224.17	5946839.68	SV20	1748110.36	5946889.77		
WM68	1748229.33	5946824.61	SV21	1748183.51	5946788.41		
WM69	1748269.96	5946816.76	SV22	1748183.27	5946789.15		
WM70	1748271.06	5946817.06	SV24	1748187.64	5946774.19		
WM71	1748297.26	5946825.52	SV25	1748187.83	5946774.78		
WM72	1748298.18	5946825.83	SV27	1748236.99	5946805.16		
MB01	1748242.38	5946841.58	SV29	1748250.82	5946809.99		
PEET VALVES							
PV06	1748200.58	5946917.62	SV30	1748251.18	5946809.80		
PV18	1748126.68	5946893.75	SV31	1748241.07	5946791.70		
PV19	1748127.13	5946893.52	SV32	1748241.67	5946791.87		
PV23	1748183.72	5946788.88	SV34	1748255.05	5946796.47		
PV26	1748236.22	5946804.91	SV35	1748255.24	5946795.79		
PV28	1748236.55	5946805.40	SV36	1748314.83	5946816.13		
PV33	1748241.50	5946791.36	SV37	1748315.17	5946816.04		
FIRE HYDRANTS							
FH01	1748194.01	5946930.08	SV38	1748314.99	5946815.79		
FH02	1748121.49	5946906.87	SV39	1748226.57	5946883.10		
FH03	1748183.11	5946789.57	SV40	1748277.39	5946957.46		
FH04	1748270.99	5946815.84					
FH05	1748226.43	5946883.55					

- NOTES**
- ALL WORK AND MATERIALS COMPLIES WITH AC STANDARD FOR ENGINEERING DESIGN AND CONSTRUCTION.
  - PIPE BEDDING COMPLIES WITH AC STD DETAIL DRAWING 18000 SHEET 4.4 UNLESS OTHERWISE NOTED.
  - WATERMAINS ARE AN AVERAGE 0.6m BELOW GROUND IN BERMS AND 0.9m BELOW GROUND UNDER ROADS. HARDFILL BACKFILLED BENEATH ROAD CROSSINGS.
  - ALL PIPES ARE LAID 1.4m OFF THE ROAD RESERVE BOUNDARY IN THE COMMON SERVICE TRENCH.
  - PIPE SIZES SHOWN ARE EXTERNAL DIAMETER.
  - LOT BOUNDARIES ARE SUBJECT TO FINAL SURVEY.
  - ASBUILT DATA HAS BEEN SOURCED FROM A COMBINATION OF WOODS SURVEY MEASURED DATA AND CONTRACTOR RECEIVED DATA.

**LEGEND**

EXISTING WATERMAIN	---
HIGH PRESSURE WATERMAIN	---
SLUICE VALVE	SV
PEET VALVE	PV
FIRE HYDRANT	FH
BLANK CAP	J
STAGE BOUNDARY	---

**REVISION DETAILS**

NO	DESCRIPTION	BY	DATE
1	ISSUED FOR INFORMATION	KR	14/03/19

SURVEYED	WOODS	WOODS Ltd LEVEL 1 BUILDING B 3 NUGENT STREET, GRAFTON AUCKLAND 1023 09 308 9229 WOODS.CO.NZ
DESIGNED	TB	
DRAWN	KR	
CHECKED	TB	
APPROVED	JW	



**MILLDALE  
STAGE 1B**

**WATERMAIN  
ASBUILT PLAN**

STATUS	ISSUED FOR INFORMATION	REV
SCALE	1:750 @ A3	1
COUNCIL	AUCKLAND COUNCIL	
DWG NO	P17-295-01B-600-AB	

**WATERCARE SERVICES LTD**  
Network As-Built Approval

As-built Number: 93730

Engineer: Nita D.

Date: 05/06/2019

I certify that these As-built Plans are an accurate record of the works undertaken and that:

- The coordinates (X,Y) are in terms of NZTM on NZGD2000
- The Levels (Z) are in terms of Auckland Vertical Datum 1946 (MSL) LINZ datum

Signed: Jamie Whyte  
Registered Professional Surveyor

Date: 28/03/2019

Name: JAMIE WHYTE

# Schedule of Land and Assets to Vest in Council

## Sheet 1: Four waters



Developer's name and address:  
 Fulton Hogan Land Development Ltd.  
 40 Flexman Place  
 Silverdale  
 AUCKLAND

Notice for assets vested from a development at:  
 Site address: Milldale Stage 1B  
 Suburb: Milldale  
 Sub / Land use consent #: SUB60067244  
 Eng approval #: ENG60308816  
 Construction Practical Completion date: 14-Mar-19

All values are to be exclusive of GST

Four Water Assets to Vest				
Stormwater				
Category	Measure		Cost / Value	Council's Contribution
	Unit	Quantity		
<b>Stormwater pipes</b>				
300mm Ø Class 2 RCRRJ	m	428.35	\$74,012.43	
300mm Ø Class 4 RCRRJ	m	158.94	\$32,635.15	
375mm Ø Class 2 RCRRJ	m	99.04	\$19,171.17	
375mm Ø Class 4 RCRRJ	m	60.35	\$12,568.23	
450mm Ø Class 2 RCRRJ	m	78.02	\$22,344.15	
525mm Ø Class 2 RCRRJ	m	76.84	\$25,092.10	
525mm Ø Class 4 RCRRJ	m	10.06	\$3,333.58	
<b>Stormwater manholes</b>				
1050mm Ø	No	17	\$63,540.25	
1200mm Ø	No	1	\$4,798.75	
1800mm Ø	No	5	\$46,522.69	
<b>Cesspits</b>				
Single	No	23	\$87,421.16	
<b>Raingardens</b>				
	No	35	\$202,936.56	
<b>Lot and Raingarden Connections</b>				
100mm Ø stub	No	145	\$13,319.70	
150mm Ø stub	No	139	\$19,035.00	
100mm Ø saddle on 225mm Ø and larger pipes	No	24	\$14,369.04	
			<b>Subtotal:</b>	<b>\$641,099.96</b>
<b>Wastewater</b>				
uPVC SN16 150mm Ø	m	518.16	\$52,334.16	
uPVC SN16 300mm Ø	m	172.96	\$28,313.55	
<b>Manholes</b>				
1050mm Ø	No	14	\$66,905.26	
1200mm Ø	No	4	\$51,925.44	
			<b>Subtotal:</b>	<b>\$199,478.41</b>
<b>Water Supply - Potable</b>				
<b>Pipes</b>				
63mm Ø PE80 PN12.5 SDR11	m	422.00	\$15,208.88	
125mm Ø PE100 PN12.5 SDR13.6	m	351.50	\$20,896.68	
250mm Ø PE100 PN12.5 SDR13.6	m	349.00	\$43,373.72	
355mm Ø PE100 PN12.5 SDR13.6	m	173.00	\$36,151.81	
<b>Valves</b>				
Peet valves on 50mm Ø line	No	9.00	\$7,296.84	
Sluice valves on 100mm Ø line	No	16.00	\$24,192.00	
Sluice valves on 200mm Ø line	No	11.00	\$30,228.66	
Sluice valves on 300mm Ø line	No	5.00	\$29,708.60	
<b>Fire Hydrants</b>				
on 100mm Ø line	No	2.00	\$4,129.10	
on 200mm Ø line	No	3.00	\$11,210.13	
<b>Water meter bank</b>				
	No	1.00	\$5,382.00	
			<b>Subtotal:</b>	<b>\$227,778.42</b>
<b>This information is certified as being true and correct</b>				
Name: Tim Brock				
Company: WOODS				
Position of signatory in relation to developer: Consulting Engineer				
Signed:				
Dated: 5/4/19				

# Schedule of Land and Assets to Vest in Council

## Sheet 2: Land, Roothing and Parks



**Developer's name and address**  
 Fulton Hogan Land Development Ltd.  
 40 Flexman Place  
 Silverdale  
 AUCKLAND

Notice for assets vested from a development at:  
**Site address:** Milldale Stage 1B  
**Suburb:** Milldale  
**Sub / Land Use Consent #:** SUB60067244  
**Eng approval #:** ENG60308816  
**Construction Practical Completion date:** 14-Mar-19

*All values are to be exclusive of GST*

Land to Vest			
Land Use	Area (m <sup>2</sup> )	Cost / Value	Council's Contribution
Roothing	14134.60	\$565,384.00	
Recreation Reserve	3687.00	\$147,480.00	
Local Purpose Reserve	3124.00	\$124,960.00	
Other - Accessway			

Roothing				
Category	Measure		Cost / Value	Council's Contribution
Roothing (must match RAMM sheet entries)	Area (m <sup>2</sup> )	5603.2	\$230,294.78	
Footpaths (including Pram Crossings)	Area (m <sup>2</sup> )	2544.60	\$157,048.00	
Kerb & Channel/Nib (including drains)	Length (m)	1150.00	\$100,203.60	
Dish channels	Length (m)	70	\$9,362.40	
Street Lights	No.	16.00	\$55,550.00	
Traffic Signals	No.	-		
Traffic Signs	No.	16.00	\$7,730.00	
Driveway	Area (m <sup>2</sup> )	-		
Catchpits	No.	23.00	\$87,421.16	
Double Catchpits	No.			
Retaining Walls	Item			
Fences	Item			
Noise Walls	Length (m)	-		
Trees	No.	29.00	\$29,224.75	
Subtotal:			\$676,834.69	

Parks			
Bridges - Pedestrian	No.	-	
Stream Landscaping	Area (m <sup>2</sup> )	3124.00	\$38,550.16
Footpaths	Area (m <sup>2</sup> )		
Fences	Length (m)	20	\$3,394.00
Planter Boxes	No.	-	
Playgrounds	No.	-	
Accessways/carparks	Area (m <sup>2</sup> )	-	
BBQ	No.	-	
Litterbin	No.	-	
Picnic Tables	No.	-	
Seats/benches	No.	-	
Subtotal:			\$41,944.16

Other			
Buildings	Item	-	-

**This information is certified as being true and correct.**

**Name:** Tim Brock  
**Company:** WOODS  
**Position of signatory in relation to developer:** Consulting Engineer  
**Signed:**   
**Dated:** 3/4/19